

## **Delegated Decision**

**27 November 2024**

**Temporary Traffic Regulation Order**

**Ordinary Decision/Key Decision No.**



---

## **Report of NEIGHBOURHOODS & CLIMATE CHANGE**

**Paul Anderson – Strategic Highways Manager, Technical Services**

### **Electoral division(s) affected:**

Benfieldside Wards: Cllrs S Robinson, K Earley

### **Purpose of the Report**

To consider a request for temporary traffic regulation by Order on 6 January 2024 for the purpose of flood alleviation sewer works on Valley Gardens, Bridgehill, Consett.

### **Recommendation**

It is recommended that the Council exercises its powers under the Road Traffic Regulation Act 1984 to effect a Temporary Traffic Regulation Order to facilitate the proposed works

### **Background**

Works are proposed by NWL / Mott Macdonald to undertake flood alleviation sewer works within the confines of the highway.

### **Options**

Other traffic management arrangements have been considered and the most appropriate method is for temporary road closure for approx. 6 weeks

### **Recommendation**

The recommendation is approved and that following, consultations with the Chief of Police, arrangements be made to progress the advertising of Public Notices and sealing of an Order.

---

**Contact:** Steven Galloway

Tel: 03000 267095

---

---

## **Appendix 1: Implications**

---

### **Legal Implications**

TTRO checked, prepared and advertised via Legal Services

### **Finance**

Costs to be charged to the scheme/applicant.

### **Consultation**

Chief of Police, Local Members, Public Transport Providers (via the Public Transport Team)

### **Equality and Diversity / Public Sector Equality Duty**

N/A

### **Human Rights**

No impact

### **Crime and Disorder**

N/A

### **Climate Change**

N/A

### **Staffing**

Network Management Team

### **Accommodation**

N/A

### **Risk**

N/A

### **Procurement**

Advertising in a public newspaper with costs recharged to the scheme/applicant

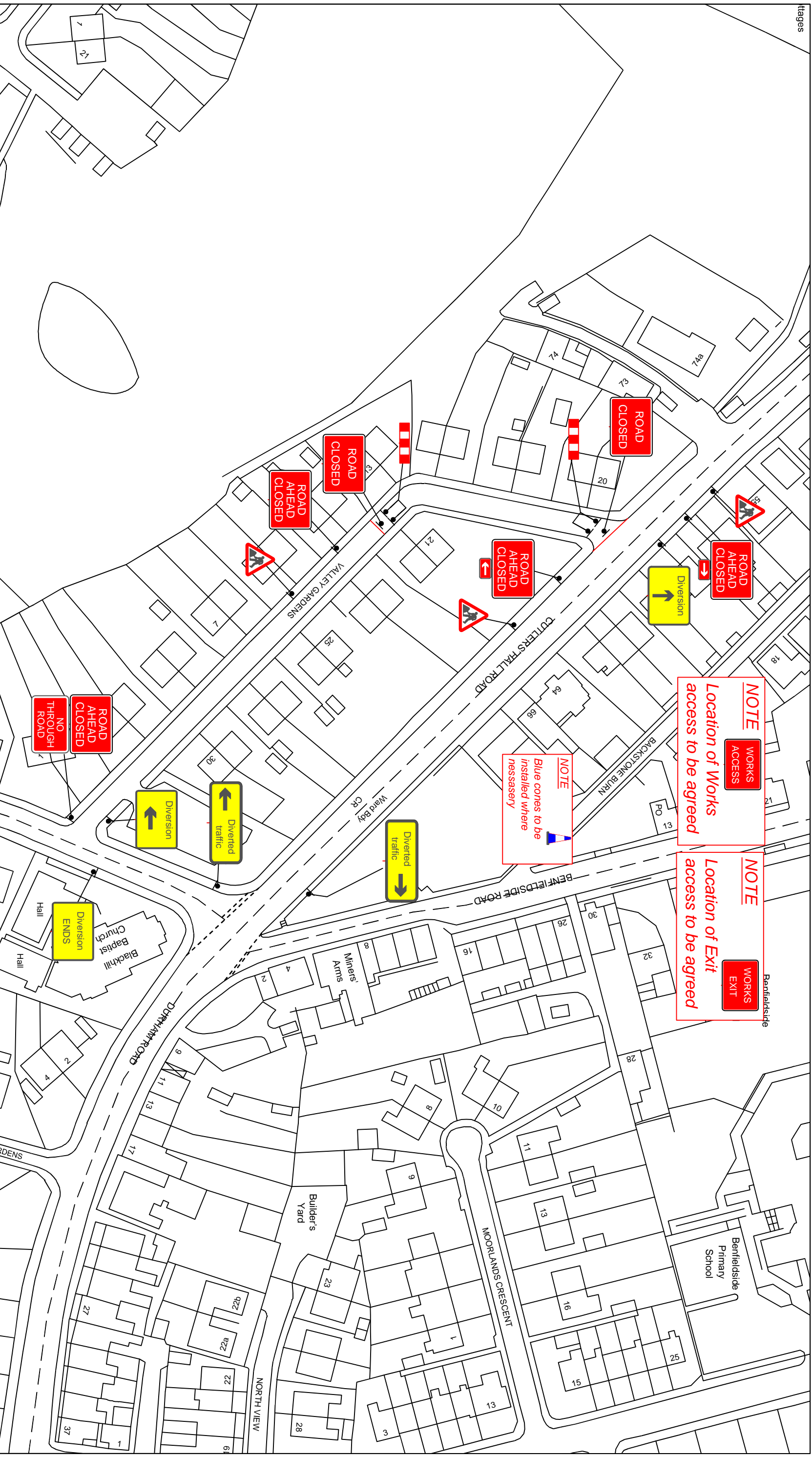

- NOTES**
1. All signs signs and cones to be placed from the date of issue.
  2. All signs signs and cones to be placed from the date of issue.
  3. All signs signs and cones to be placed from the date of issue.
  4. All signs signs and cones to be placed from the date of issue.

**NOTE**  
WORKS ACCESS  
Location of Works access to be agreed

**NOTE**  
WORKS EXIT  
Location of Exit access to be agreed

**NOTE**  
Blue cones to be installed where necessary

DESIGNER CHECK LIST	Yes	No
Is an access system required?	<input checked="" type="checkbox"/>	<input type="checkbox"/>
Have you been informed of any overhead obstructions in GSE?	<input checked="" type="checkbox"/>	<input type="checkbox"/>
Have you been informed of any significant risks of persons and plant involved?	<input checked="" type="checkbox"/>	<input type="checkbox"/>

RESTRICTION ON STOPPING WITHIN WORKS	Yes	No
Have you been informed of any significant risks of persons and plant involved?	<input checked="" type="checkbox"/>	<input type="checkbox"/>

**Premier**  
TRAFFIC MANAGEMENT LTD

Unit 5 Eagle Industrial Estate,  
Torre Road, Leeds, LS9 7QL.  
Tel: 01302701013

CLIENT: [Blank]

PROJECT TITLE: [Blank]

Address: **Cutlers Hall Road**  
**Durham**  
**DH8 8RD**

DATE: **12 November 2024**

REV No: [Blank] REV DETAILS: [Blank]

DRAWING No.: **PTM.CAD.3188.003**

STATUS:  FOR ISSUE  CONSTRUCTED

SCALE: N.T.S.